

Data sheet - Support roller STO 20TN (crowned, with inner ring)

Designation	STO 20
Type	crowned
D [mm]	47
d [mm]	20
F, Fw * [mm max.]	25
B1 [mm]	16
B [mm]	15,8
d1 [mm]	32
r [mm]	0,3
Dynamic load Crw [N]	16200
Static load C0rw [N]	21500
Speed limit [min-1]	4700

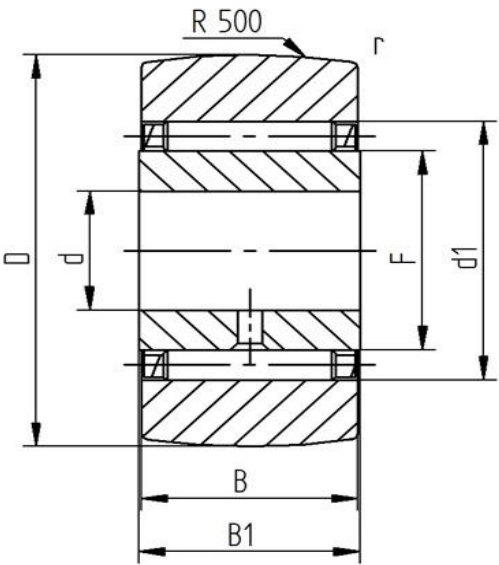

Every specification has been edited and verified carefully. STI Bearings GmbH assumes no liability for potential errors or incompleteness. Technical modifications are subject of changes.  
 © 2020 by STI Bearings GmbH  
 Reproduction, even excerpts, only with our approval.